

**BOMAG OSZILLATION  
BW 161 ADO-4**

**PERFORMANCE DATA**

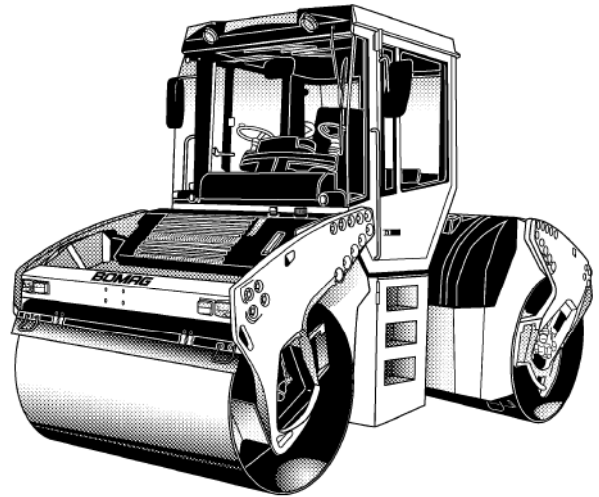

Machine type	Compaction output (m <sup>3</sup> /h) at recommended soil layer thicknesses		
	Gravel, sand	Mixed soil	Silt, clay
BW 161 ADO-4	140-280	120-250	65-130

Machine type	Compaction output (t/h) at different asphalt layer thicknesses		
	2-4 cm	6-8 cm	10-14 cm
BW 161 ADO-4	35-70	70-150	100-180

# Technical Data

Shipping dimensions in m3      without ROPS with ROPS  
**BW 161 ADO-4**                      19,679                      25,447

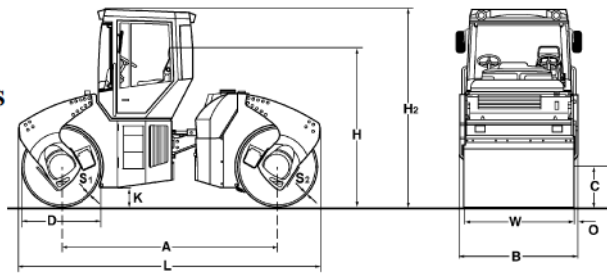

## Standard Equipment

- Front drum vibration: 2 amplitudes / 2 frequencies
- Rear drum Oscillation: 1 Amplitude/ 2 frequencies (Highly wear resistant drum)
- Crab-walk to both sides (170mm)
- Autom. vibration operation
- Vibration and oscillation individually switchable
- Operator's platform with:
  - two steering wheels
  - Rotable and laterally sliding seat
- 2 travel levers with integrated switches for vibration
  - + Edge pressing roller
  - + Crab walk
- Pressure sprinkling system with 2 pumps
- Back-up alarm
- Battery disconnect switch

## Optional Equipment

- ROPS cabin with seat belts + heating, Ventilation + 4 Working head lights
- \*Indicator and hazard lights
- ROPS cabin with air conditioning
- ROPS/FOPS with safety belt
- Rotary beacon
- Edge cutter
- Folding scrapers
- Special painting
- Environmentally compliant hydraulic oil
- Sun roof
- Radio
- Precision spreader
- Asphalt temperature display
- Electronic Engine Immobilizer
- Approval by the German TÜV
- BOMAG TELEMATIC
- Outside mirrors

\* Standard delivery with CE conformity (valid within European Union)

## Dimensions in mm

	A	B	C	D	H	H2	K	L	O	S1	S2	W
<b>BW 161 ADO-4</b>	3300	1840	715	1220	2320	3000	350	4610	80	17	13	1680

## Technical Data

### Weights

Operating weight CECE w. cab. ....	kg	9.400
Axle load, front CECE .....	kg	4.900
Axle load, rear CECE .....	kg	4.500
Static linear load, front CECE .....	kg/cm	29,2
Static linear load, rear CECE .....	kg/cm	26,8
Grossweight .....	kg	11.100

### Dimensions

Track radius, inner .....	mm	4.400
---------------------------	----	-------

### Drums

Split drum .....	no
------------------	----

### Driving Characteristics

Speed (1) .....	km/h	0- 5,7
Speed (2) .....	km/h	0- 11,0
Max. gradeability without/with vibr. ....	%	40/35

### Drive

Engine manufacturer .....	Deutz	
Type .....	TCD 2011 L04 w	
Emission stage .....	3a/3	
Cooling .....	water	
Number of cylinders .....	4	
Performance ISO 14396 .....	kW	74,9
Speed .....	min-1	2.300
Electric equipment .....	V	12

### Brakes

Service brake .....	hydrost.
Parking brake .....	mech.

### Steering

Steering system .....	oscil.artic.	
Lateral displacement right/left .....	mm	170

### Exciter system

Vibrating drum .....	front	
Autom. vibr. shut off .....	standard	
Frequency .....	Hz	40/50
Amplitude .....	mm	0,94/0,42
Centrifugal force .....	kN	107/74
Centrifugal force .....	t	10,9/7,5
Oscillating drum .....	rear	
O. Frequency 1 / 2 .....	Hz	35/43
O. Amplitude 1 / 2 .....	mm	1,38/1,38

### Capacities

Fuel .....	l	200,0
Water .....	l	1.000,0

Technical modifications reserved. Machines may be shown with options.



PRE 920 70 001

071113 Sa01

**BOMAG**  
 Hellerwald  
 D-56154 Boppard  
 P.O. Box 5162  
 Tel. (0)6742 - 1000  
 Fax (0)6742 - 3090

